

(WS-FO-338) SEWER APPLICATIONS

I/we the builder/plumber for this property hereby make application to have the following works/services carried out and pay any applicable fees and ongoing annual charges as set out in Councils Revenue Policy.

Gravity Main Extension ☐ Pressure Sewer Connection/Extension ☐
(Must have an approved Plan) (Includes Grinder Pump Unit)
Type of Fee: ☐ Private (fees applicable) ☐ Pre-paid
Is this application part of a D/A? ☐ Yes - D/A No. _____ / _____ ☐ No

DETAILS OF PROPERTY / PREMISES:

Owners Name(s): _____
House/Farm Number: _____ Street/Road Name: _____
Town/Village: _____
Lot No: _____ Section No: _____ DP No: _____
Parcel No: _____ Assessment No: _____

TYPE OF PREMISES: (Tick only one)

☐ Residential ☐ Non-Residential ☐ Commercial ☐ Industrial

☐ Other (please state) _____

If non- residential, commercial or industrial, approximate No. of persons employed at premises: _____

Is a pool or spa proposed: Yes ☐ / No ☐

Will there any trade waste discharged from the site: Yes ☐ / No ☐

For a Non-Residential Development, further details may be required.

Note: A connection generating trade waste will require a separate form.

APPLICANTS DETAILS: (for the Builder):

Applicants Name: _____

Postal Address: _____

Phone Number: _____ Fax Number: _____

Email: _____

Signature of Applicant: _____ Date: _____

Signature of Property Owner: _____ Date: _____

(Property Owner must sign form)

Grinder Pump Information Pack received by applicant: (Signature) _____

Note: The builder's electrician shall carry out electrical works as detailed in the pamphlet to ensure that Council can commission and operate the grinder pump, otherwise the pressure sewer unit will not be connected.

SEWER APPLICATIONS

**FORM**

(Blanks not to be photocopied. Print direct from DAKS)
(Printed on 04-Feb-20 at 16:02)

GENERAL SITE SKETCH TO BE COMPLETED BY THE APPLICANT (Low Pressure Sewer):

The site plan shall include the proposed position of all buildings, shedding, pool, pathways, drives and other site improvements including the main switch board. The plan shall also include lot boundaries, dimensions, north point, street/road names and include: **the distance to nearest intersecting street or road and also include the preferred location of pressure sewer tank, boundary kit and control panel in relation to the house** (please complete below or attach a site plan with the above details).

Nearest Side Road/Street

Nearest Side Road/Street

House / Farm / Lot No.....

Street/ Road Name.....

Please Note: A connection may take up to 20 working days to complete.

OFFICE USE ONLY

Checked by _____ Signature _____
(Customer Service Officer - Print Name)

Amount Paid: \$ _____ Date Paid _____ Receipt No: _____

Gravity Sewer Connection

D/A - Receipt Code **668SJCI** - Job No. 131120 / 521 / 899

No D/A Receipt Code **356** - Job No. 131120 / 521 / 899

Pressure Sewer Connection

D/A - Receipt Code **663PSC** - Job No. 131147 / 541 / 849

No D/A Receipt Code **500** - Job No. 131147 / 541 / 849

CRM No: _____

W&S Administration Officer to complete – Pressure Sewer Connection

Grinder Pump Information Pack received by Applicant: Yes ☐ N/A ☐

Copy of Installation Guidelines handed to Applicant (Attached on form): Yes ☐ N/A ☐

Original Application to Inspector Utilities: Yes ☐

Utilities Inspector to complete

Low Pressure Sewer (Grinder) or Gravity Main Sewer - Application No: _____

Provide notification to Plumber for installation and date Yes ☐

Email Store of Pickup of Collection Tank by Plumber (Job No. 135260 / 224 / 100) Yes ☐ N/A ☐

Copy of Application for grinder unit to Water Billing officer (*once installed*): Yes ☐

Asset and as constructed details recorded Yes ☐

Low Pressure Sewer Letter and documents sent to owner Yes ☐ N/A ☐

(Trim No.18/76810)

Provide comments on CRM & close Yes ☐

_____ (Utilities Inspector to sign) _____ (Date)

Comments _____

Approved: Quality Systems Supervisor	Group / System: Utilities	Document ID: WS-FO-338	Version: 11
Relevant to: Water & Sewerage	Date Issued: 4 Sept 2012	Revised: 4 February 2020	Status: Approved
			Page: 2 of 5

INFORMATION ON SEWERAGE GRINDER PUMPS FOR THE BUILDER

The property to which this application applies is to be serviced by a pressure sewerage system. What this means is that sewerage from the dwelling / business is to be collected in a below ground level tank and then pumped from the property.

To ensure trouble free installation and commissioning, please note the following:

Application form and conditions of Work:

- You, as the Builder is making application on behalf of the owner. Council notes that you are the applicant and all correspondence will be between Council and yourself;
- Ensure all details as requested on the form are provided. A contact phone number is essential if further information regarding the application is required.
- If you are making a non-residential application, you will need to provide an approximate number of employees on the premises once the business is fully operational. If the business will be discharging waste to sewer other than normal toilet and sink usage, consultation with Council is mandatory and may also require the completion of a Notification to Discharge application. This will need to be addressed in the early stages as a different pumping unit or additional trade waste facilities may be required, possibly resulting in delays.
- A boundary kit may already been installed in either one of the front corners of your block. You should see a black rectangular plastic lid at ground level. If you are unsure or cannot locate it, please contact Council. If a boundary kit has not been provided, one will be installed by Council as part of the overall pressure sewer installation.
- The depth of the sewer at the collection tank must not exceed 1.1 metres. Without allowing for passive or adverse block profile, this depth allows for up to 45 metres of gravity sewerage pipework leading into the pump station. It is preferred to keep the distance between the property fixtures and the collection tank to a minimum and avoid expensive pressure sewer unit relocation. The collection tank will need to be located on the same side of the lot as the boundary kit and clear of driveways or within garden beds. If in doubt, contact Council.
- An alarm panel will be installed as part of the pressure sewer system. The panel is equipped with a red alarm light that will illuminate in the event of a fault. The panel shall be visible from the collection tank and from the street for service purposes. The alarm panel shall be no more than 10 metres from the collection tank and be mounted on the outside wall of the dwelling. The panel may be mounted on a remote stand subject to approval by Council and the additional cost of cabling and the stand is to be met by the applicant.
- Once the application has been approved, the Applicant shall contact Council's Utilities Inspector regarding the works in order to verify and program the works. Planning for the installation including application and coordination of the various stages of install shall be the sole responsibility of the applicant who will maintain contact with Council's Utility Inspector throughout the course of the work.
- Works carried out by the Builder will take into account the need for Council's accredited installer to provide an electrical conduit from the alarm panel to the collection tank at 500mm depth and mechanical protection of the cable under the panel.
- Works carried out by Council includes installation of the collection tank, alarm panel (to wires provided by others), property discharge pipe, boundary kit (and hot tap to the main if not provided) and full commissioning that may require multiple visits.

Approved:	Quality Systems Supervisor	Group / System:	Utilities		Document ID:	WS-FO-338	Version:	11	
Relevant to:	Water & Sewerage	Date Issued:	4 Sept 2012	Revised:	4 February 2020	Status:	Approved	Page:	3 of 5

FORM

(Blanks not to be photocopied. Print direct from DAKS)
(Printed on 04-Feb-20 at 16:02)



Boundary Kit



Alarm Panel



Remote Stand

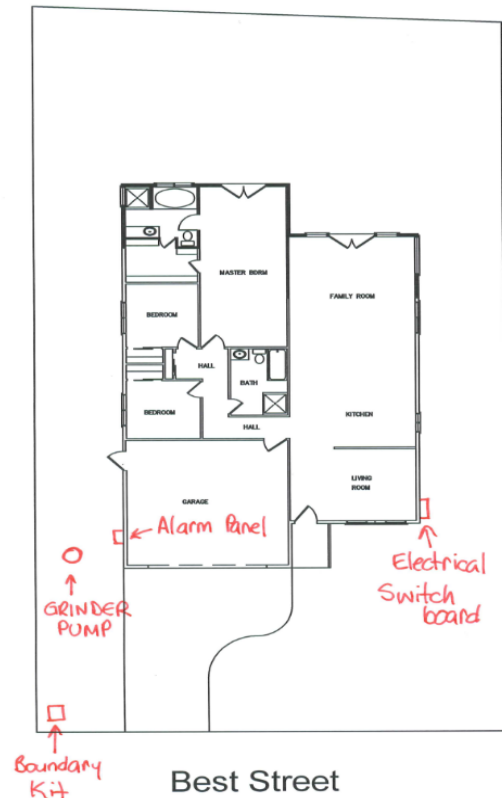

General Arrangement

