

# ***Griffith Regional Sports Precinct***

# The Project

- Plan, design & construct a multi-purpose, high quality sports complex for the Western Riverina @ Westend Oval (\$18.8m est)
- A 50M Pool & amenities @ GRALC (\$6m est)
- Develop partnerships with other organisations to deliver a range of outcomes ie PCYC, schools, community and sporting groups

# Features

- 7 indoor courts (usable for Basketball, Volleyball, Badminton, Netball, Futsal etc)
- New kiosk, change rooms, office space, storage and toilets
- 7 outdoor netball courts
- 1 x outdoor Basketball ½ court
- New synthetic Athletic track
- A new artificial turf Hockey pitch
- A new grandstand
- Retain existing Cricket wicket
- New parking and drop off areas

# Locations

## Westend Oval & GRALC

- Council is Trustee therefore controls both of the sites (a key requirement for funding)
- Builds on existing infrastructure to provide best outcome for the community
- Central location for both sites
- Provides best operating cost synergies into the future i.e. whole of life costing efficiencies maximized by operating single sites

# Benefits

- Increase participation in sports in the community & improve pathways for talent
- Reduce need for residents to travel out of town for events
- Attract regional and state sports/other events to the city unlocking sports tourism  
\$\$\$\$\$
- All local schools (secondary & primary) will be major winners

# Now

- Completed Draft Concept Plans – Westend Oval & 50M Pool at GRALC
- Successful in EOI process
- A Sports Precinct Master Plan developed
- Griffith Sports Council members consulted
- In discussion with key partner stakeholders
- Letters of support obtained
- Capital & Operational Budgets prepared
- Preparations underway for Business Case, detailed concept plans & QS (not detailed design yet)



# Communications

- Griffith Sports Council - ongoing
- Community
- PCYC - high level discussion has taken place, interest in the proposal
- NSW Department of Education - both local and state level, ongoing
- NSW State Government - various departments including Premier & Cabinet, ongoing

# Funding

- NSW State Government – Regional Sports Infrastructure Fund \$10M
- GCC - \$10M plus in-kind support
- PCYC - \$1M ongoing discussion
- Education NSW - \$3.5M ongoing discussion
- Joint Use initiative;
  - r.e. Murrumbidgee Regional High School



# Griffith Sports Precinct Master Plan

Revised 20/2/2018

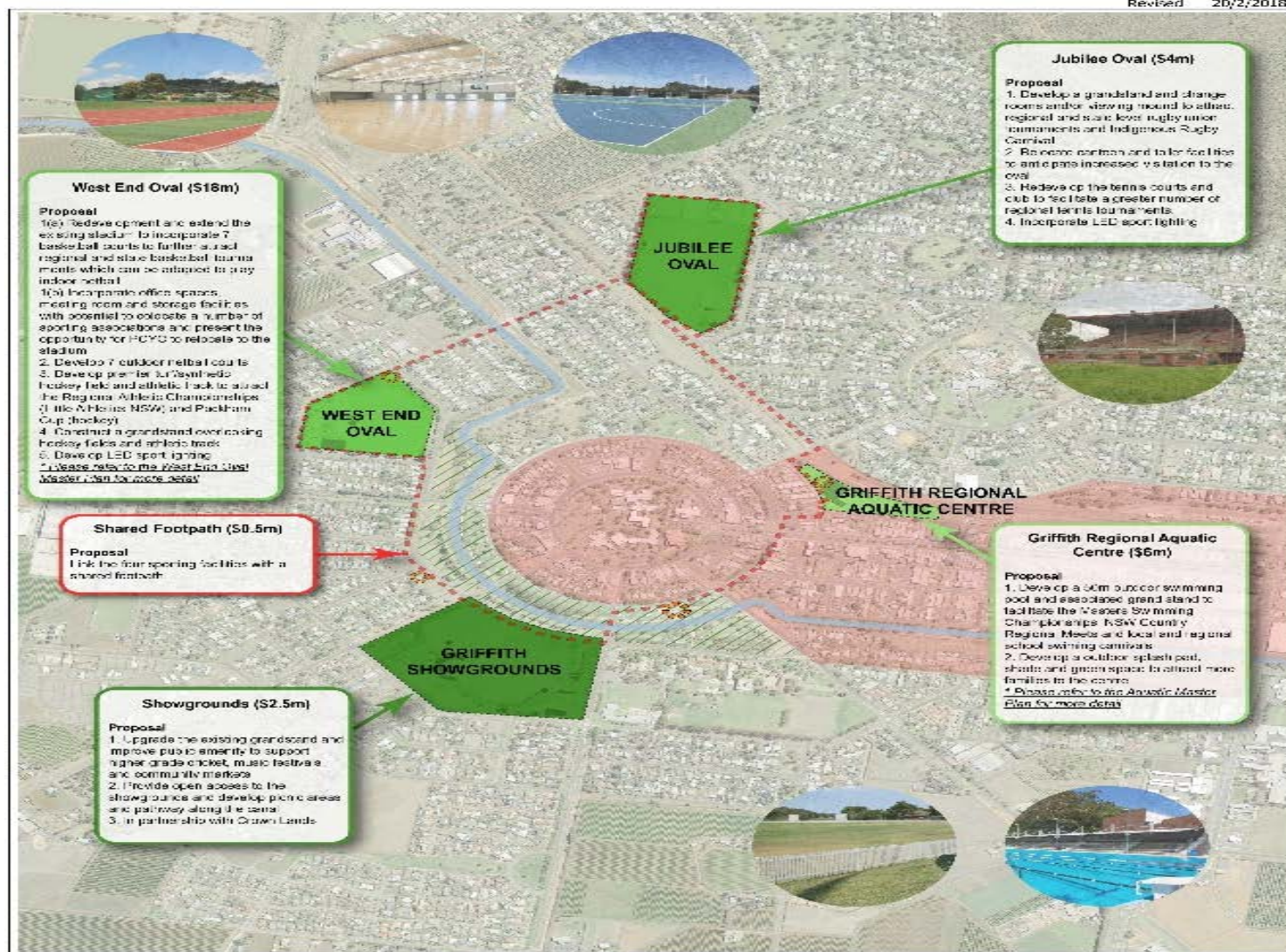

## GRIFFITH SPORTING PRECINCT MASTER PLAN

LEGEND:	
	Shared Pathway
	Playground
	Open Space Network
	City Centre



Version 5 (20 February 2018)

Map Scale: 1:10000 at A3

# Westend Oval Concept Plan

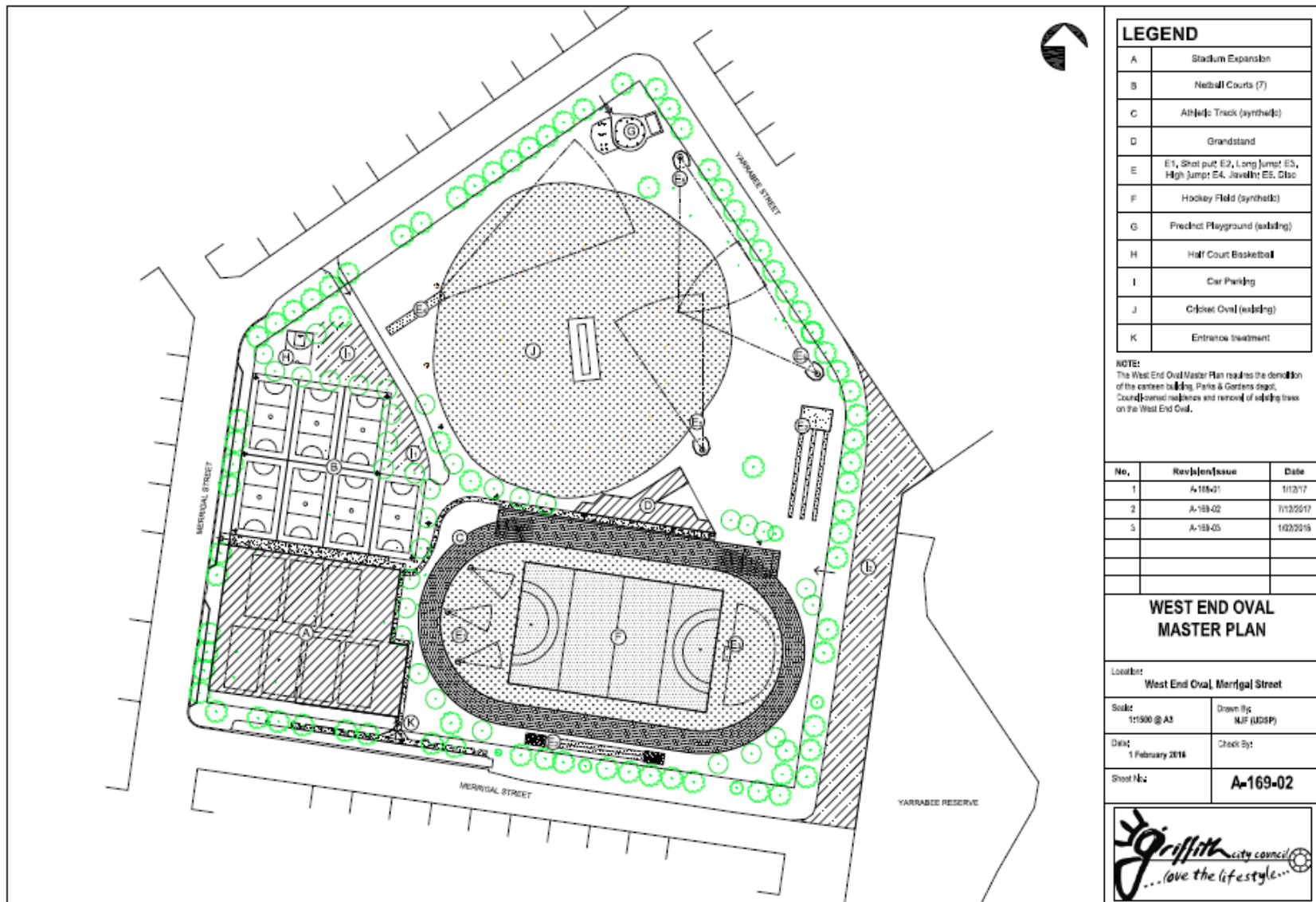



# Westend Oval Concept Plan

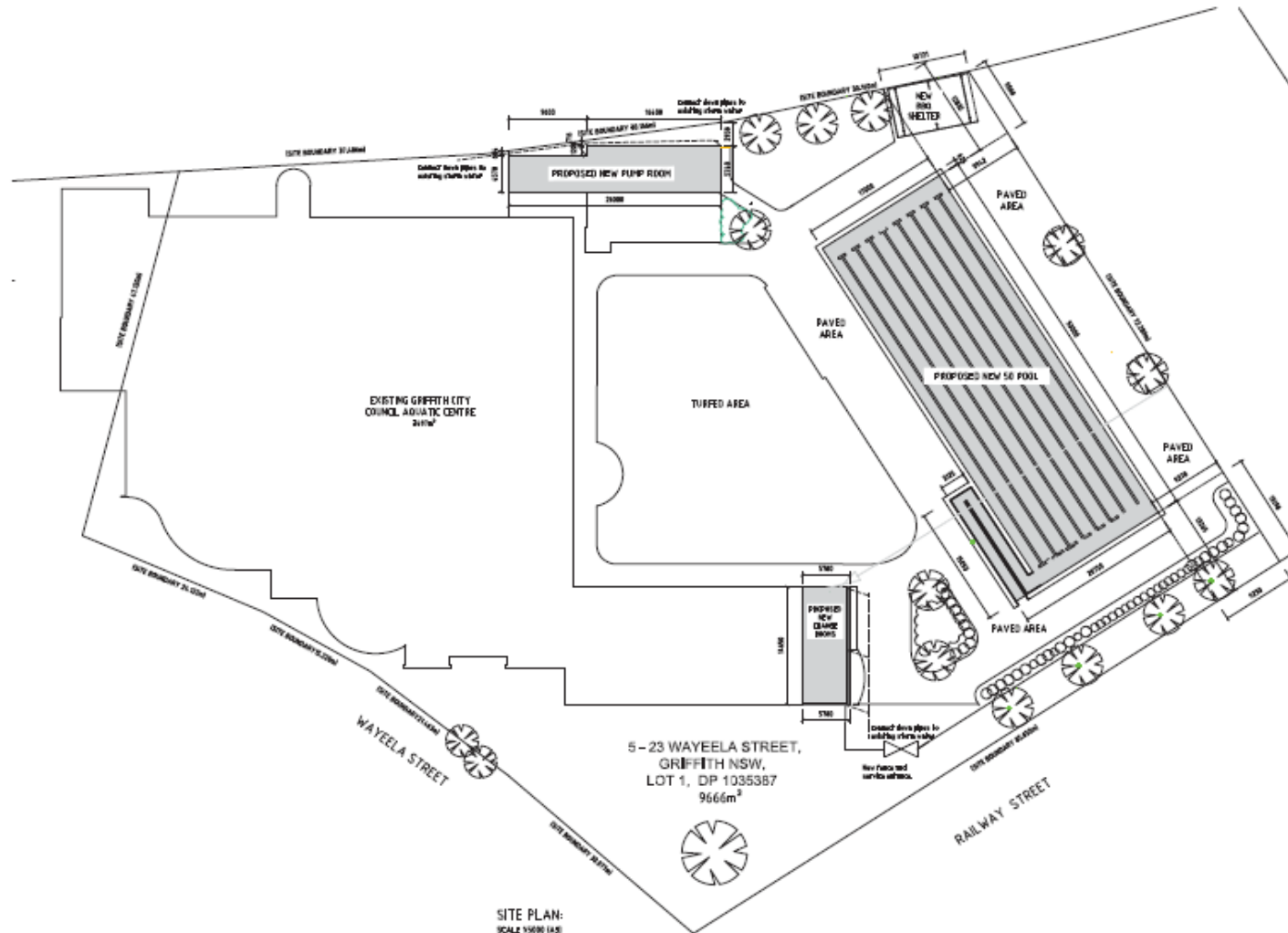

SITE PLAN:  
SCALE 1:500 (A3)

**FOR APPROVAL**

DATE	DATE	DATE



**GRIFFITH CITY COUNCIL**

PROJECT:  
DEMOLITION OF EXISTING SKATE PARK  
AND PROPOSED NEW 50 METER POOL,  
CHANGE ROOMS AND PUMP ROOM AT  
GRALC

<b>SITE PLAN</b>			
DATE	DATE	DATE	DATE
DATE	DATE	DATE	DATE
DATE	DATE	DATE	DATE

# Considerations

- Closure of part of Yarrabee Street, essential for expanded bus drop off & parking requirements
- Disruption to sports at Westend Oval during construction
- Demolition of old skatepark to enable 50M Pool - new one already in place
- GRALC Carparking:
  - 77 spaces in Couchman's Carpark
  - 54 spaces in GRALC Carpark
  - Potential for more parking in Olympic Street

# Next

- Complete preparation of Business Case, detailed concept plan, QS
- Lodge Business Case by 31/8/2018
- Successful applicants to be announced by 31/12/2018
- Further community consultation to take place to inform preparation of final detailed design for both facilities
- Project to be completed by 3 years from execution of funding agreement
- For further information, visit Councils website at [www.Griffith.nsw.gov.au](http://www.Griffith.nsw.gov.au)